



Mounting aid MH-EXG-12

- Clamp for threaded pipe
- Suitable for all M12 sensors, including reduction factor 1
- Simple and quick exchange without readjustment
- 2 panel nuts included
- Free of paint wetting interfering substances
- Significantly reduced influence on the switching distance

Quick mounting bracket with dead stop

Dimensions

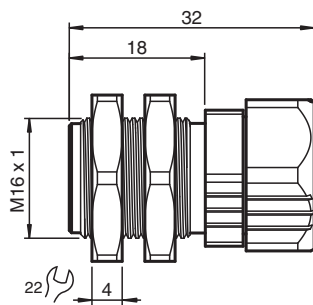

Technical Data

Ambient conditions		
Ambient temperature		-40 ... 90 °C (-40 ... 194 °F)
Mechanical specifications		
Length	L	32 mm thread length of sensor min. 32 mm
Diameter		sensor min. 11.8 mm sensor max. 12 mm
Material		brass, nickel-plated free of paint wetting interfering substances
Screwed connection		SW = 22 mm
Dimensions		M16 x 1 external thread
Tightening torque		20 Nm
General information		
Note		Attention: Sensor shape dependent, it will be fixed up to 0.7 mm in back-flush position.

Release date: 2022-12-19 Date of issue: 2022-12-19 Filename: 70112557_eng.pdf

Refer to "General Notes Relating to Pepperl+Fuchs Product Information".

Pepperl+Fuchs Group
www.pepperl-fuchs.com

USA: +1 330 486 0001
fa-info@us.pepperl-fuchs.com

Germany: +49 621 776 1111
fa-info@de.pepperl-fuchs.com

Singapore: +65 6779 9091
fa-info@sg.pepperl-fuchs.com

PF PEPPERL+FUCHS

Mounting

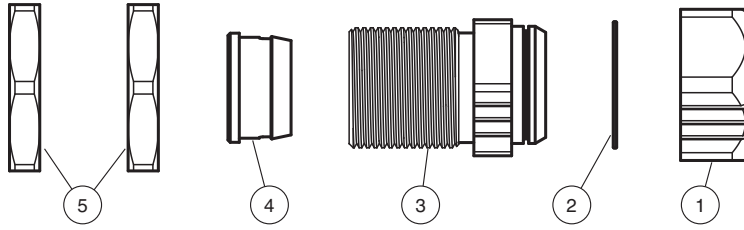

Release date: 2022-12-19 Date of issue: 2022-12-19 Filename: 70112557_eng.pdf